

Flat 13, Garamond Court Somerset Street, Redcliffe, Bristol, Sold @ Auction £189,000



- FOR SALE BY ONLINE AUCTION
- WEDNESDAY 24TH JULY 2024
- VIDEO TOUR NOW ONLINE
- VIEWINGS - REFER TO DETAILS
- LEGAL PACK COMPLETE
- SOLD @ JULY ONLINE AUCTION
- LEASEHOLD 2 BED FLAT
- 2ND FLOOR | PARKING
- COSMETIC UPDATING | VACANT
- EXTENDED 8 WEEK COMPLETION

Hollis Morgan – JULY LIVE ONLINE AUCTION – A Leasehold 2 BED | 2ND FLOOR FLAT (489 Sq Ft) in need of COSMETIC UPDATING with PARKING.

Flat 13, Garamond Court Somerset Street, Redcliffe, Bristol, BS1 6FH

Accommodation

FOR SALE BY LIVE ONLINE AUCTION

*** SOLD @ JULY ONLINE AUCTION ***

GUIDE PRICE £160,000 +++
SOLD @ £189,000

ADDRESS | Flat 13, Garamond Court, Somerset Street, Redcliffe, Bristol, BS1 6FH

Lot Number 2

The Live Online Auction is on Wednesday 24th July 2024 @ 17:30
Registration Deadline is on Monday 22nd July 2024 @ 16:00

The Auction will be streamed LIVE ONLINE via the Hollis Morgan website & you can chose to bid by telephone, proxy or via your computer.
Registration is a simple online process – please visit the Hollis Morgan auction website and click "REGISTER TO BID"

THE PROPERTY

A vacant leasehold second floor two bedroom purpose built flat (489 Sq Ft) in this popular block with communal parking.
Sold with vacant possession.

Leasehold - 999 years less 3 days commencing on and including 29 September 1987

Ground Rent - Annual peppercorn

Management Fee - £110 pcm

Council Tax Band - B

Sold with vacant possession.

THE OPPORTUNITY

VACANT FLAT | COSMETIC UPDATING

The flat has been let for many years and now requires cosmetic updating but has scope for a fine home or investment in this sought after central location.
Please refer to independent rental appraisal.

LOCATION

The property is located only a short walk away from not only Bristol Temple Meads but a range of shops, bars and restaurants located in the City Centre and Bristol's vibrant floating harbour.

Also Wapping Wharf which is only a stones throw away, has rapidly become a much-loved part of Bristol, reflecting the independent spirit for which Bristol has become famous. From sourdough pizzas to organic fruit and vegetables, and from freshly baked bread to specialist coffees, Wapping Wharf is home to a plethora of independent eateries, spanning everything from fine dining to street food.

Floor plan

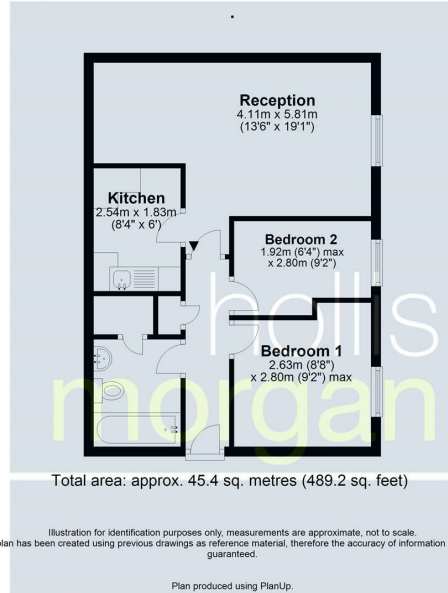

EPC Chart

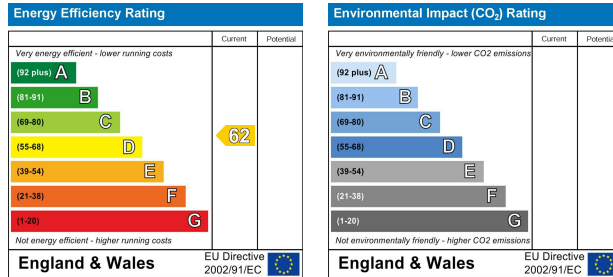

9 Waterloo Street

Clifton

Bristol

BS8 4BT

Tel: 0117 973 6565

Email: post@hollismorgan.co.uk

www.hollismorgan.co.uk

Hollis Morgan Property Limited, registered in England, registered 7275716.

Registered address, 5 Upper Belgrave Road, Clifton, Bristol BS8 2XQ

Auction Property Details Disclaimer

Hollis Morgan endeavour to make our sales details clear, accurate and reliable in line with the Consumer Protection from Unfair Trading Regulations 2008 but they should not be relied on as statements or representations of fact.

Please refer to our website for further details.